

Harry  
the hirer.<sup>®</sup>  
Productions

the  
STUDIO

SYDNEY MELBOURNE

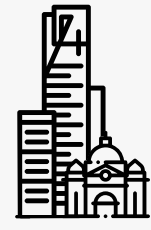

## THE STUDIO MELB

*Richmond, Melbourne.*  
With an aura of an underground hideaway, this modern industrial space located close to the city, boasts 350sqm of versatile space to accommodate all manner of broadcasting and live streaming productions.



## THE STUDIO SYD

*Homebush, Sydney.*  
This 250sqm purpose built studio housed in our Sydney Olympic Park venue, utilises high end technology whilst offering clients a comfortable professional experience.

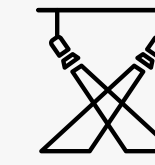

## FULLY EQUIPPED

Cameras  
Studio lighting  
Audio & Mics  
High gloss Harlequin flooring  
Furniture options

Fold back monitors  
Digital vision mixing  
Digital audio mixing  
LED screen backdrops  
Green room space

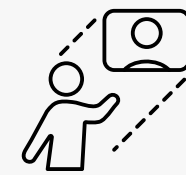

## REMOTE PRESENTER

If you can't make it to us, we can come to you. We have the ability to film and broadcast your presenters remotely from any location. The signal is sent to our editing and broadcast studio and streamed to your audience live. You have a front seat in the production with comms live from the site, and the ability to direct and communicate to our team.

We can provide solutions for any remote based presenters to join your virtual event.



# THE SPACES

## MELBOURNE

## SYDNEY

### STUDIO DIMENSIONS

Standard format

**361sqm**

Inhouse rigging max trim height 6.0m

Standard format

**257sqm**

Inhouse rigging max trim height 5.5m

### BACK OF HOUSE

Loading in and out vehicle access doors

**2.7m x 2.7m**

(wide)

(high)

Loading in and out vehicle access goods lift

**1.2m x 2.1m**

(wide)

(high)

### AUDIENCE CAPACITY

Seated

**150**

Seated

**50**

### GREEN ROOM

Level 1 overlooking studio  
Client comfort complete with lounges

Large business suite format including  
performer pre-show spaces

### STUDIO CONTROL ROOM (MELB ONLY)

- Live Production & Streaming Software
- Dedicated video editing machine with 70 inch screen
- LX Pre-vis software loaded includes MA-3D and others.
- Time code system included

### FURNISHINGS (BOTH STUDIOS)

Access to full range of onsite HTH furniture and décor accessories available to fit out studios as required.

# THE KIT

## LIGHTING

- TourPro Studio Soft Panel lights
  - Moving lights
- Grand MA & Hog 4 control

## AUDIO

- Control – DigiCo / Allen and Heath or similar
  - Mics - Shure ULX-D Radio mic kits

## VISION

- BlackMagic Constellation
- BlackMagic ATEM 2 M/E Advance panel
  - Roland and Ascender vision control
- vMix live production and streaming software
- BlackMagic HyperDeck video playback and record with redundancy

## LED SCREENS

- Melbourne - 2.08mm pitch LED (raiseable)
  - 10mm pitch LED movable columns
- Sydney – 2.56mm pitch Black LED

## COMMUNICATIONS

- ClearCom – 4 Channel Talkback System
  - Unity Intercom – Remote comms

# BROADCAST

## OUTDOOR BROADCAST

- Magewell Ultra Encode SRT
  - RUTX12 4G router

## PLATFORMS

- Zoom/Zoom Rooms
  - Webcast Cloud
- RTMP platforms such as Facebook Live, Vimeo, Youtube etc.

## STREAMING DETAIL

- Internet**
  - 200 megabit up/down fibre connection
  - 1 gigabit fibre link between studios
- Server**
  - Content Dedicated high speed FTP server allowing for live content transfer.

## REDUNDANCY

- Fully integrated redundancy across video and audio output devices.
  - Encoder and streaming redundancy to all studios.

# INFINITY WALL

## INFINITY WALL

- Melbourne only**
  - 3.6m high 3 sided curved wall
    - 6m x 3m stage
  - 7m x 4m presentation space
- Robert Juliat Dalis 863 Asymmetric Colour Adjustable
- Cyclight 3.6m x 1.5m overhead LED softbox (cutter)

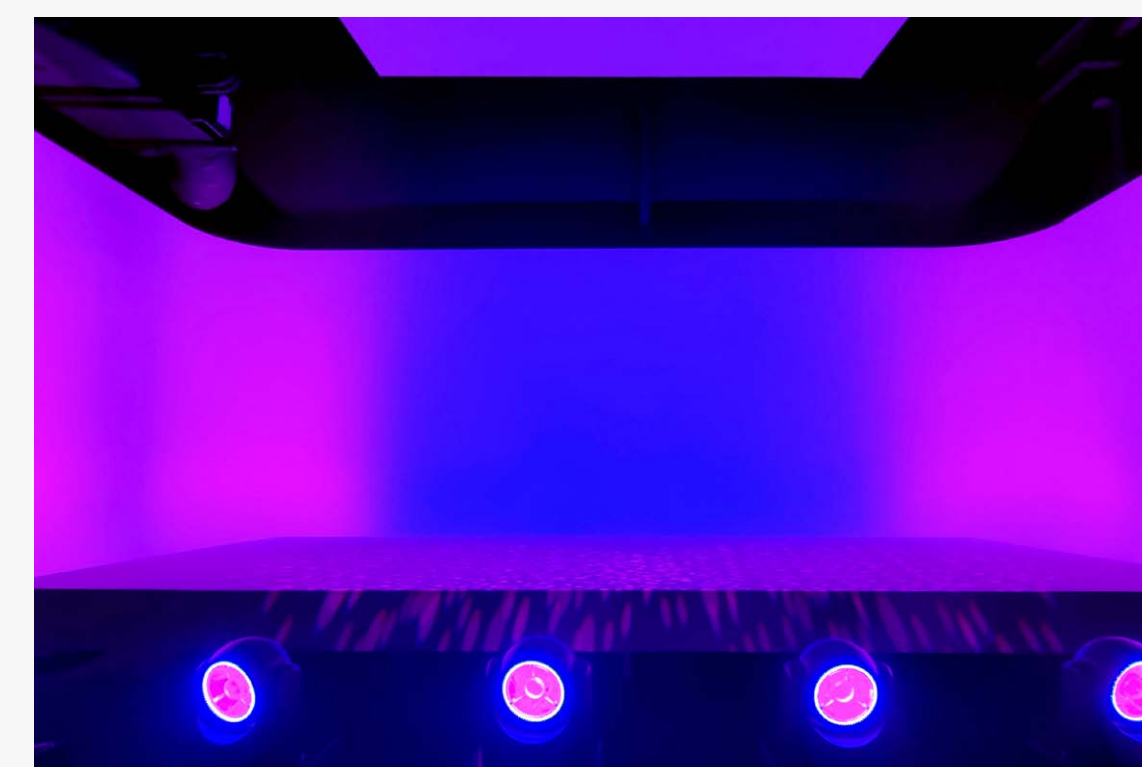
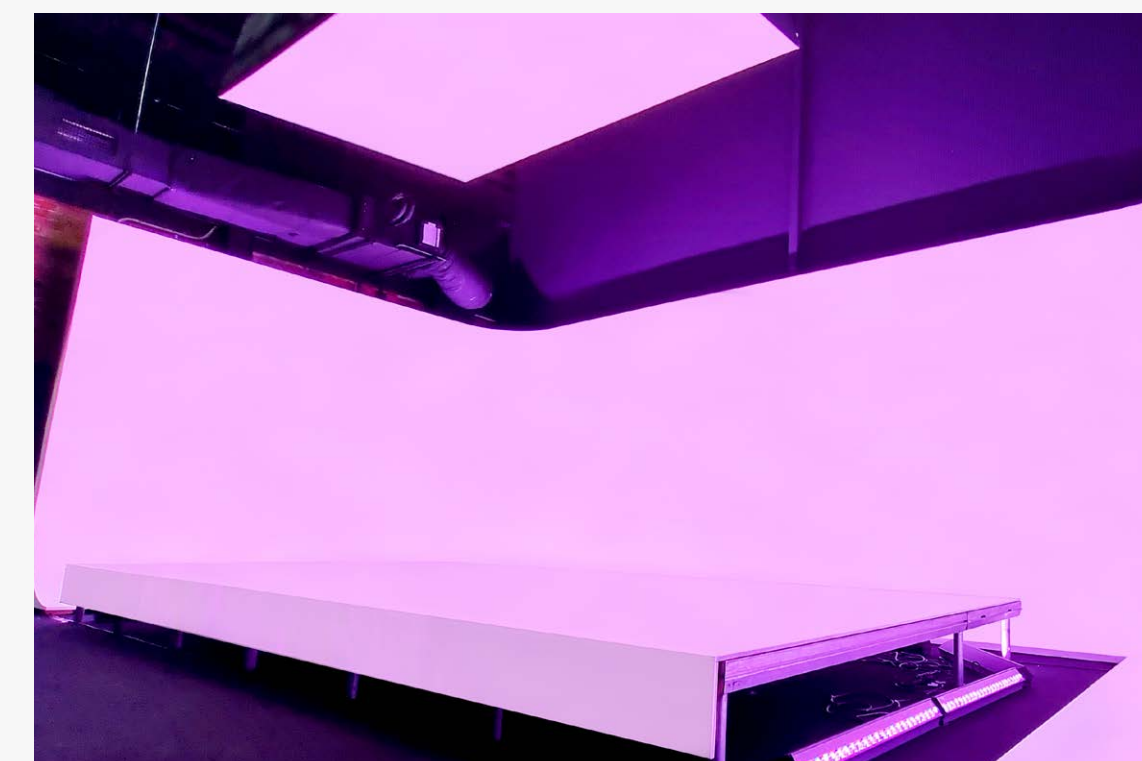





# PACKAGES

EQUIPMENT	PACKAGE ONE	PACKAGE TWO	PACKAGE THREE
Panasonic AG-CX350 4k Camera	-	x 1	x 2
Wally Dolly camera tracks	-	x 1	x 2
TourPro Soft Panel Studio Lights	x 6	x 6	x 10
Shure Mic kit	x 1	x 2	x 4
55" Fold Back monitors	x 2	x 2	x 3

## EQUIPMENT INCLUDED IN ALL PACKAGES

Panasonic PTZ Camera (Remote Controlled)	2.5mm LED backdrop	10mm LED FX columns
BlackMagic Constellation and ATEM 2 M/E Advanced Panel	BlackMagic HyperDeck playback and record with redundancy	DigiCo S21 Digital Audio Console
4 channel Clearcom intercom w/Unity integration	Perfect Cue wireless presenter system	Countdown Presentation Timer
Dedicated multiple UPS systems for redundancy on video, audio and LX control	Motorised truss grid available for set elements	Preset lighting bar locations for additional elements
Grand MA & Hog 4 control	Integrated teleprompter system available at additional cost	Purpose built broadcast / streaming control room
	Spacious control space including dedicated Director, Teleprompter & Show-caller positions	

\*Equipment list may vary between studios



## STUDIO CONTROL ROOM

- 4 x High-end PC's w/BlackMagic 4K Decklink capture & vMix Live Production & Streaming Software
- Dedicated video editing machine with 70 inch screen
- LX Pre-vis software loaded includes MA-3D and others.
- Time code system included



The use of each studio will be varied and case by case specific. With this in mind, all jobs will be priced on a case by case basis. However, the above packages should be used as a guide to further discussions:

# MELBOURNE STUDIO

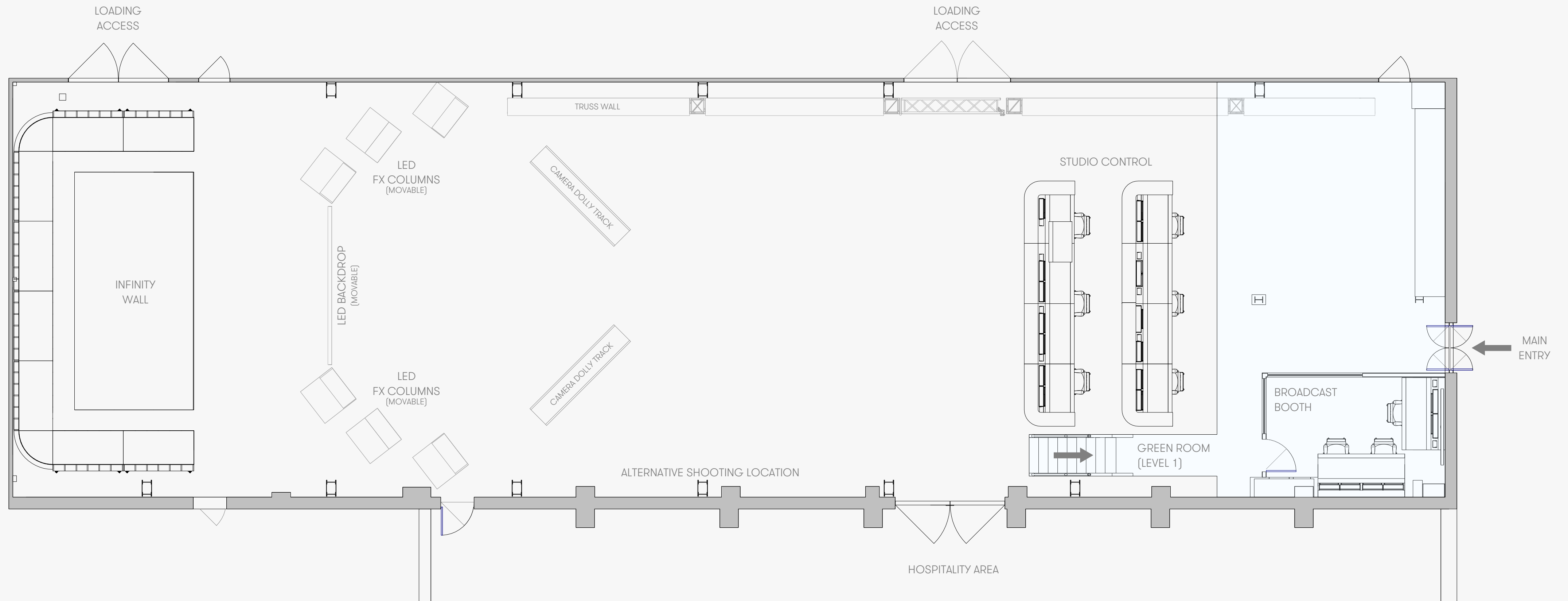

# SYDNEY STUDIO

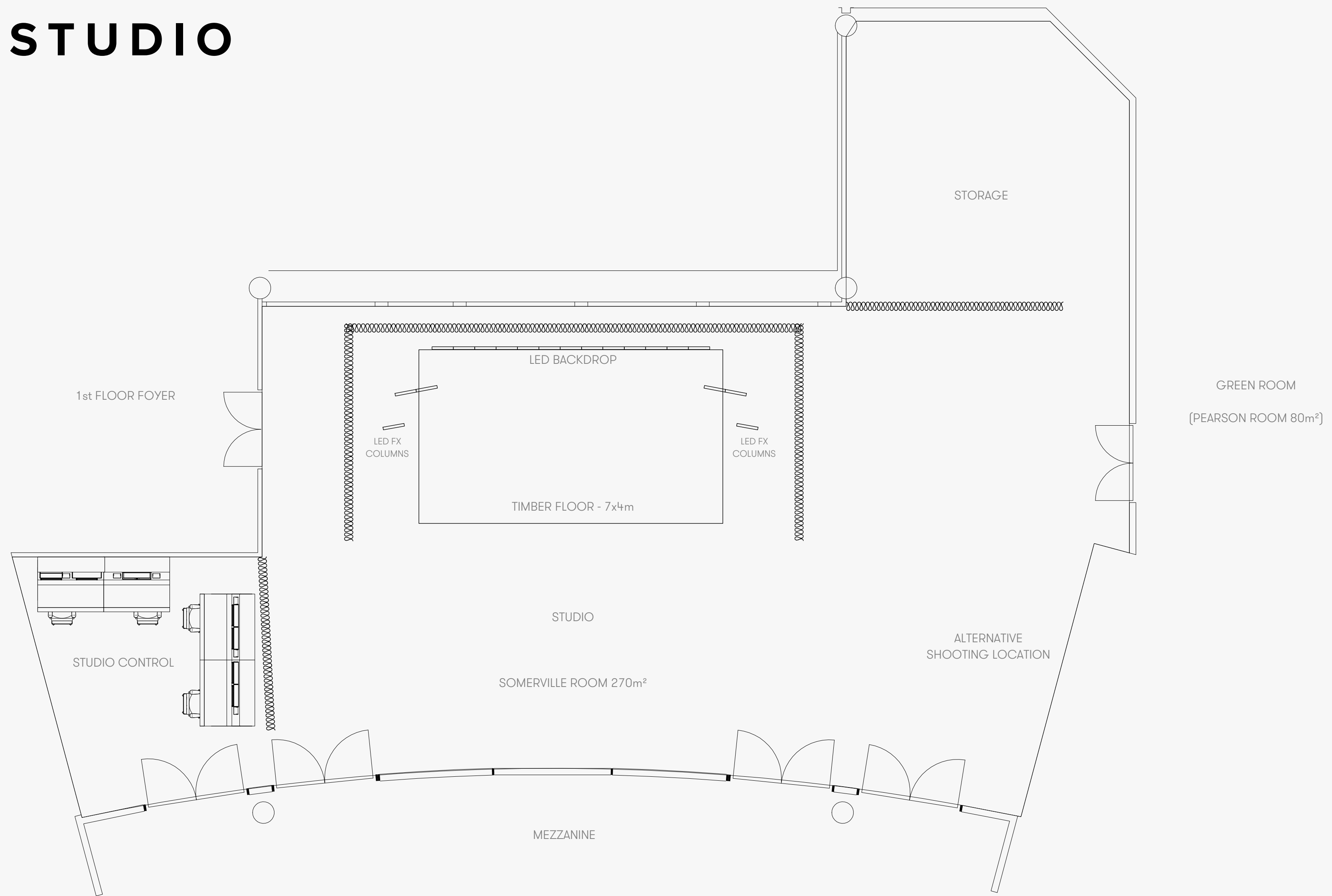



# THE DETAILS

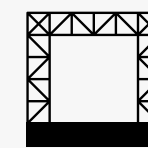

## CUSTOM DESIGNED AND BUILT STUDIO SET

Our in-house team of builders, cabinet makers, painters and signage printers are also at your disposal to create the customised look you wish to achieve.

Our bespoke furniture pieces are at your disposal to dress your set.



## HYGIENE

Based on the guidance from authorities, we have undertaken several COVID19 protective measures to be able to continue serving our customers safely and effectively. We have enhanced the cleaning procedures at our warehouses and offices.

Here are a few examples of our guidance for our employees in the current situation:

- Attendance registration is mandatory for all visitors/clients to allow for contract tracing
- Masks required as per state recommendations
- Hand sanitiser provided to all studios
- Studios and equipment are thoroughly cleaned between every job.
- Our warehouse staff have been instructed to maintain excellent hand hygiene at all times
- Any employee showing signs of illness or feeling unwell is to notify their manager immediately, and seek further advice from their state based department of health.

We will continue to monitor the situation closely and adhere to all advice of authorities.

Microphones and headsets are cleaned before and after every use.



# BOOK THE STUDIO TODAY

**Harry  
the hirer®  
Productions**

[productions@harrythehirer.com.au](mailto:productions@harrythehirer.com.au)  
Melbourne 03 9429 8666  
Sydney 02 9666 8699

