



**Sheraton®**

ON THE PARK



# Welcome

Create memories that last a lifetime: our beautiful harbour city welcomes you with a vibrant social scene, iconic landmarks and world famous beaches. Indulge in exquisite dining, premium shopping and sightseeing and unique relaxation options.

## BE OUR GUEST

With 557 guestrooms and suites (starting from 40m<sup>2</sup>), Sheraton on the Park creates a warm and comfortable environment in the heart of the city.

Available in multiple sizes and configurations, guest rooms are beautifully appointed with marble bathrooms and spacious living areas. Our 48 suites are fit for the most discerning traveller with many offering private balconies, providing panoramic views over Sydney. Suites also feature access to the Sheraton Club, Sydney's premier Executive Lounge on level 21. Sheraton Club guests benefit from a range of exclusive entitlements including light 'continental plus' buffet breakfast and pre-dinner drinks and canapés.

Whilst all guestrooms offer wireless internet access with the possibility to connect with up to three devices at a time, the Link@ Sheraton is a unique and welcoming place in the lobby for in house guests. Open 24 hours a day, the Link@Sheraton offers complimentary wireless internet access, computer docking stations, communal lounge area, newspapers and light refreshments and meals.

## DREAM DESTINATION

Sheraton on the Park offers ideal access to the best of it all. Positioned in the heart of Sydney's retail and business districts adjacent to Hyde Park, the hotel is the ideal destination from which to explore Sydney and welcomes guests to a world of famous beaches, picturesque harbours, historic cultural destinations and premium shopping at your doorstep, including David Jones and Westfield.

## SOMETHING FOR EVERYBODY

- 24 hour Concierge, Link@Sheraton and 24 hour in-room dining.
- Rooftop health club with fully equipped gymnasium, indoor heated pool, jacuzzi, steam rooms and sauna. Massage and beauty services from On The Park Rejuvenation Day Spa.
- Guest rooms feature TV with movie channels, data ports, wireless internet access throughout the property, direct dial telephone and voice mail, laundry and valet services, luxurious robes, hairdryer, in room safe, iron and ironing board, radio and minibar.

## GATHER OVER A MEAL

Culinary delights are better when shared. Enjoy excellent service and innovative cuisine at the fashionable array of dining choices at Sheraton on the Park.

The award-winning signature restaurant Feast awaits with a world of flavours on the international seafood buffet, served daily for lunch and dinner. Enjoy your favourite beverage at The Conservatory Bar whilst admiring the Hyde Park view through dramatic two storey windows or on the al-fresco terrace. Exchange stories with friends as you indulge in a traditional tea stand and revel in the chic surroundings of The Gallery Tea Lounge, or dine in the comfort of your own room with 24 hour in-room dining.

## INSPIRE NEW IDEAS

The perfect venue for motivating a successful team, Sheraton on the Park combines the ultimate in technology and style.

Accommodating from 10 to 1600 guests, the hotel is one of the largest conference hotels in the city. An abundance of natural light throughout, wireless internet access, outdoor terraces and meeting concierge services guarantee the utmost in comfort and friendly service.

Featuring over 2500 square metres of function space, 18 versatile meeting rooms, pre-function areas and break-out spaces providing the ideal space for your special event.

spg<sup>\*</sup>  
Starwood  
Preferred  
Guest

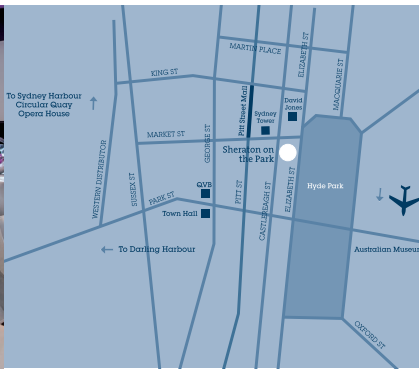

**SHERATON ON THE PARK**  
 161 Elizabeth Street, Sydney  
 New South Wales 2000  
 T 612 9286 6000  
 F 612 9286 6686  
 sheraton.com/sydney

Located in heart of CBD.  
 Location time: GMT +10 (dependent on daylight savings)  
 Distance from Sydney International Airport: 12km  
 By taxi: 15 mins (approx). One-way fare: A\$35-A\$40

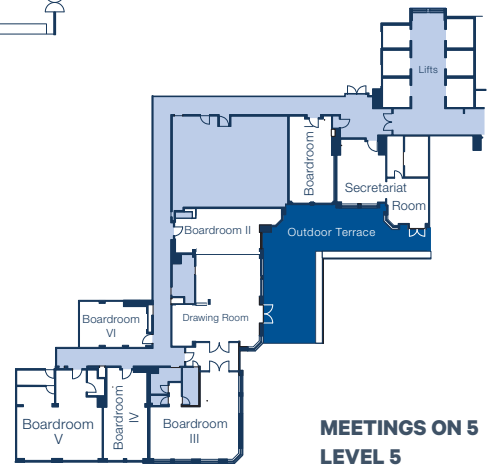
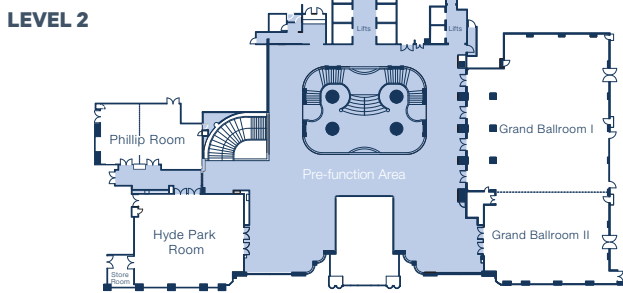
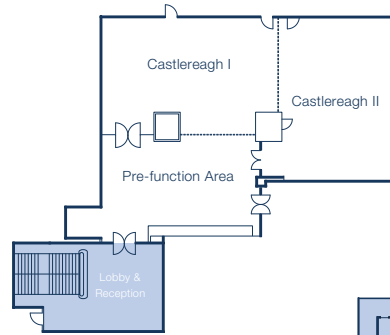
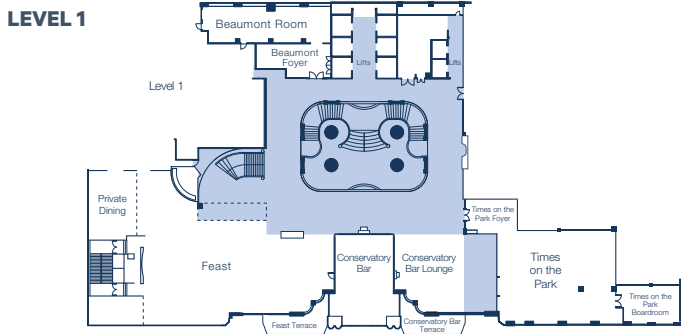

**ROOM DIMENSIONS AND SEATING CAPACITY**

**AWARD WINNING MEETING FACILITIES**

Sheraton on the Park is the perfect venue to hold your next event. Features include:

- One of Sydney's largest conference hotels with 18 flexible meeting rooms accommodating 10-1600 guests.
- Pillarless Grand Ballroom which caters for up to 900 theatre style and 550 banquet style
- Smartest meeting space in the city with full HD vision system, Meyer sound system, 150MB wireless internet connection, interactive screens and Apple TVs
- Meetings on 5 offers private boardrooms, outdoor terraces and Meeting Concierge Services
- Staging Connections, Australia's leading event staging company, is the onsite partner of Sheraton on the Park

We're more than just a meeting place; we're a member of your team. That means our attentive staff will allow you to focus on what truly matters – your guests.

2016 Australian Hotels Association (AHA) National Awards For Excellence - Best Meeting & Events Venue

2016 Tourism Accommodation Australia (NSW) Awards For Excellence - Conference Hotel of the Year

2015 Tourism Accommodation Australia (NSW) Awards For Excellence - Brasserie/Café of the Year (Hall of Fame Recipient)

2014 World Travel Awards - Australia's Leading Hotel Suite: The Royal Suite

2013, 2012 HM Awards - Australia's Best Meetings & Conference Property

2013 Tourism Accommodation Australia (NSW) Awards For Excellence - Workplace Health & Safety Hotel of the Year (Hall of Fame Recipient)

2012, 2011, 2010, 2007 New South Wales Tourism Awards - Best Luxury Accommodation (Hall of Fame Recipient)

2012, 2011 World Travel Awards - Australasia's Leading Hotel.

ROOM	Theatre	Classroom	Cocktails	Banquet	Dinner Dance	Boardroom	U-Shape	Cabaret (6 pax)	Open Ended (8 pax)	Exhibition Booths (3m x 2m)	Area m <sup>2</sup>	Height m
GRAND BALLROOM	900	360	900	550	450	-	-	300	400	40	650	4.1
BALLROOM I	500	230	500	350	250	-	-	180	240	24	420	4.1
BALLROOM II	250	144	220	180	120	-	-	120	128	12	230	4.1
LEVEL 2	-	-	1200	-	-	-	-	-	-	22	1402	2.6
HYDE PARK ROOM	220	126	200	160	110	54	48	96	120	10	180	2.6
PHILLIP ROOM	100	60	80	90	-	42	30	54	80	4	122	2.6
PHILLIP ROOM I	40	24	20	30	-	18	15	-	16	-	48	2.6
PHILLIP ROOM II	60	30	60	50	-	24	21	24	32	-	74	2.6
TIMES ON THE PARK	170	84	180	120	100	42	30	78	80	-	195	2.4
TIMES ON THE PARK BOARDROOM	24	-	20	20	-	18	15	12	16	-	35	2.9
BEAUMONT ROOM	60	-	80	60	-	30	27	30	40	-	90	2.7
CASTLEREAGH ROOM	200	110	250	150	120	60	54	96	120	-	265	3
CASTLEREAGH I	90	54	70	80	-	36	30	48	64	-	112	3
CASTLEREAGH II	90	54	70	80	-	36	30	48	64	-	105	3
SECRETARIAT ROOM & TERRACE	20	-	25	10	-	18	15	6	8	-	44 117	2.5
BOARDROOM I, II, IV	-	-	-	-	-	14	-	-	-	-	35	2.5
BOARDROOM III/ DRAWING ROOM & TERRACE	-	-	50	-	-	22	-	-	-	-	68 68 117	2.5
BOARDROOM V	50	24	30	40	-	22	21	24	32	-	38	2.5
BOARDROOM VI	-	-	-	-	-	-	12	-	-	-	29	2.5